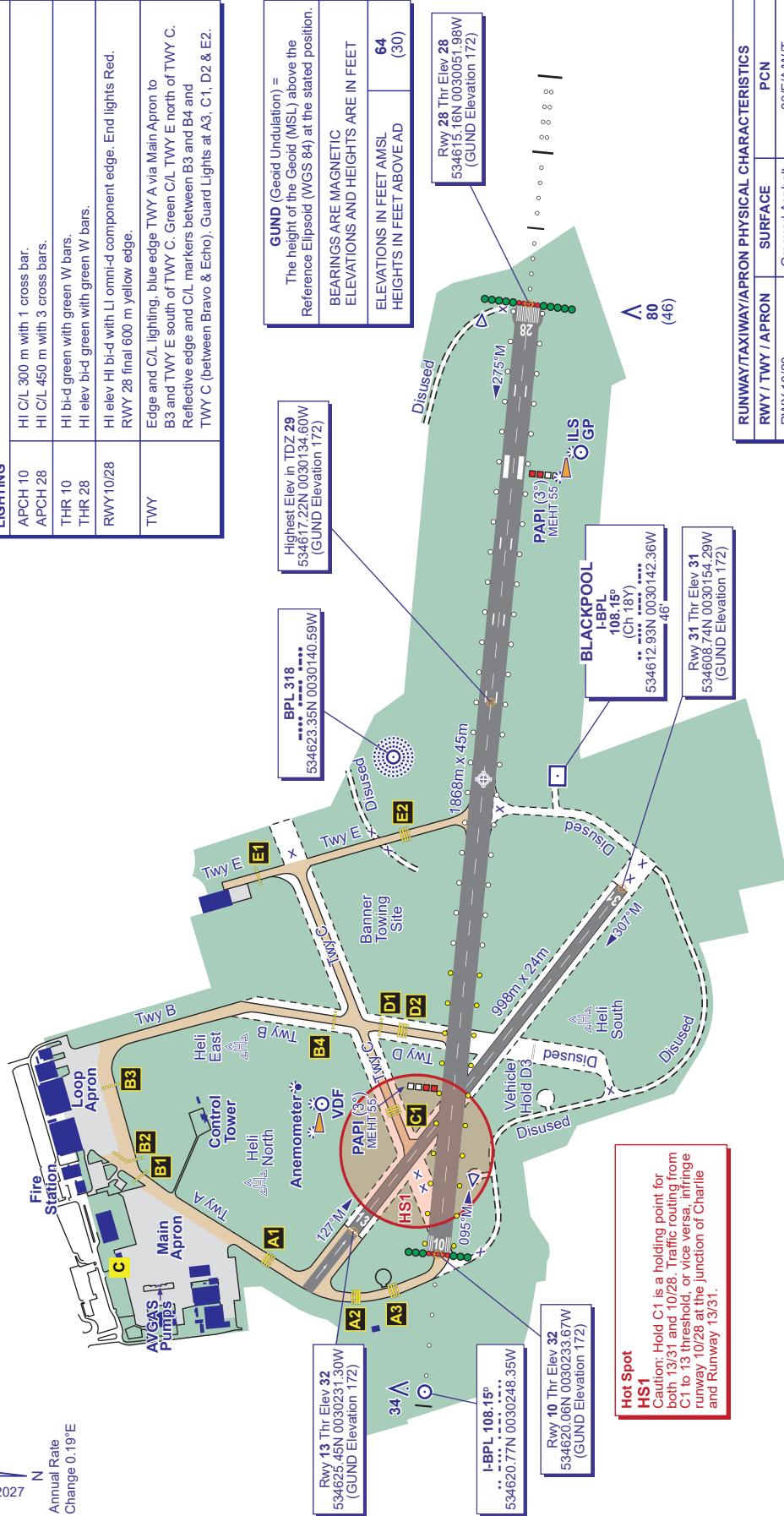
Annual Rate
of Change 0.19%E

COM		BLACKPOOL INFORMATION	
ATIS	127.205	BLACKPOOL TOWER	
TWR	119.955 (TWR/APP)	BLACKPOOL FIRE	
	121.605		
LIGHTING			
APCH 10	HI C/L 300 m with 1 cross bar.		
APCH 28	HI C/L 450 m with 3 cross bars.		
THR 10	HI bi-d green with green W bars.		
THR 28	HI elev bi-d green with green W bars.		
RWY10/28	HI elev HI bi-d with LI omni-d component edge. End lights Red. RWY 28 final 600 m yellow edge.		
TWY	Edge and C/L lighting, blue edge TWY A via Main Apron to B3 and TWY E south of TWY C. Green C/L TWY E north of TWY C. Reflective edge and C/L markers between B3 and B4 and TWY C (between Bravo & Echo). Guard Lights at A3, C1, D2 & E2.		

<p>GUND (Geoid Undulation) = The height of the Geoid (MSL) above the Reference Ellipsoid (WGS 84) at the stated position.</p>	<p>64 (30)</p>
<p>BEARINGS ARE MAGNETIC ELEVATIONS AND HEIGHTS ARE IN FEET</p>	
<p>ELEVATIONS IN FEET AMSL HEIGHTS IN FEET ABOVE AD</p>	

RUNWAY/TAXIWAY/APRON PHYSICAL CHARACTERISTICS		
RWY / TWY / APRON	SURFACE	PCN
RWY 10/28	Grooved Asphalt	33/F/A/W/T
RWY 13/31	Asphalt	14/F/A/W/T
TWY A	Asphalt	33/F/A/W/T
TWY B, C, D & E	Asphalt	14/F/A/W/T
Apron (All) See AD 2-EGNH-2-2		